

## Finding Area of Rod Designs

Use the designated number of rods as footprints to cover each rod design. Record the color names to show how you placed the rods on each design. Find the area of each rod design. (Let  = 1 square unit.)

1) Use six rods.

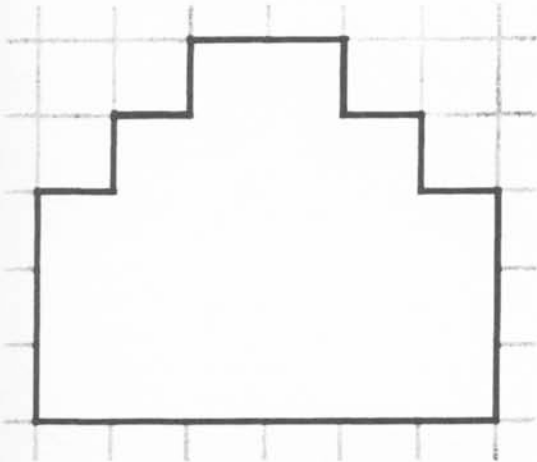

Area = \_\_\_\_\_ square units

2) Use six rods.

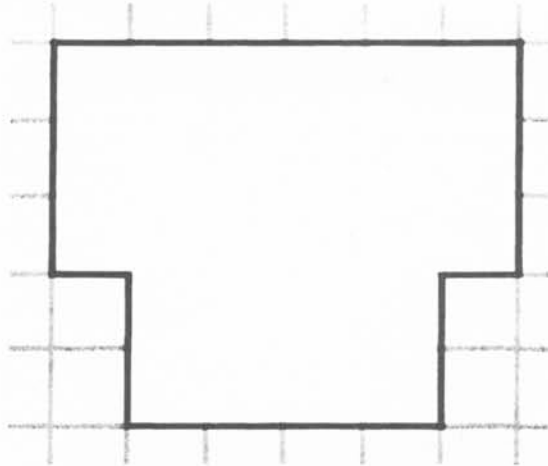

Area = \_\_\_\_\_ square units

3) Use eight rods

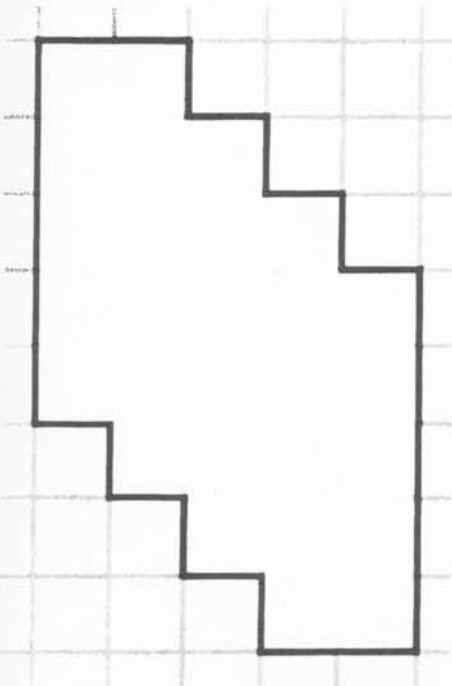

Area = \_\_\_\_\_ square units

4) Use nine rods

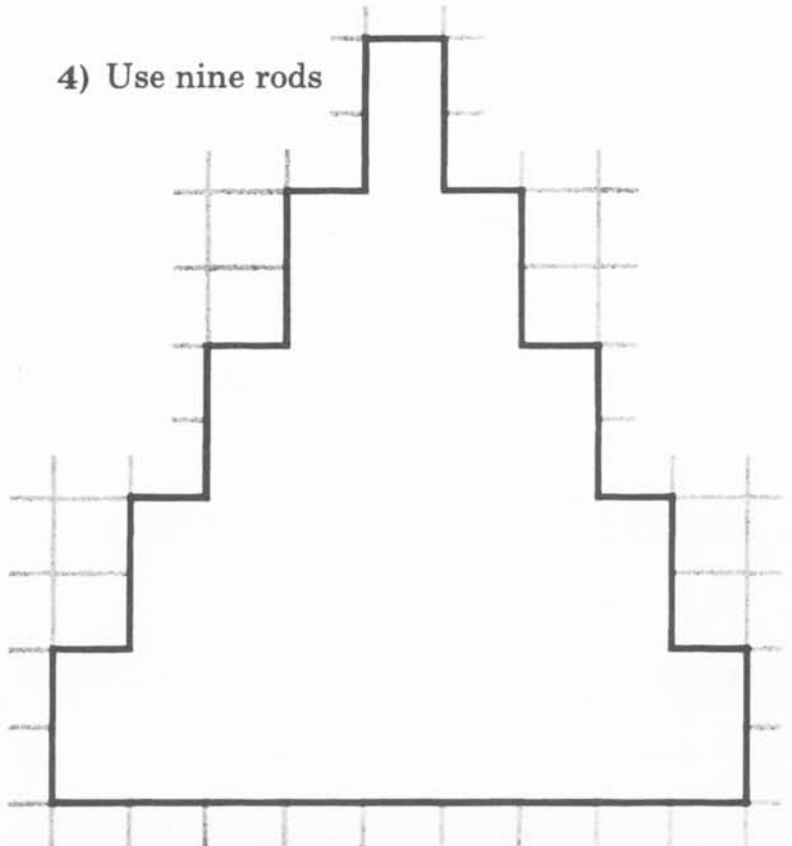

Area = \_\_\_\_\_ square units